



Contour

Architectural Wall Solutions





CP-20 - Frameless Glass Walls

Increased daylight, improved views, lower energy bills and timeless modern aesthetics are all key benefits gained through interior glass walls. Barber Glass offers one of a kind interior aluminum and glass partition systems accommodating thicknesses ranging from 8mm to 21.52mm, suitable for commercial or residential applications. Maximize the amount of light into any space with our glass wall systems where every detail has been thought out for both functionality, ease of installation and longevity during final use.

1" wide x 1" high channel in two options, fixed channel or stop-glazed channel with gaskets. Used on either the top, bottom or sides of any partition wall. To be used for single glass walls or can be tied into doors jambs with site installed corner keys

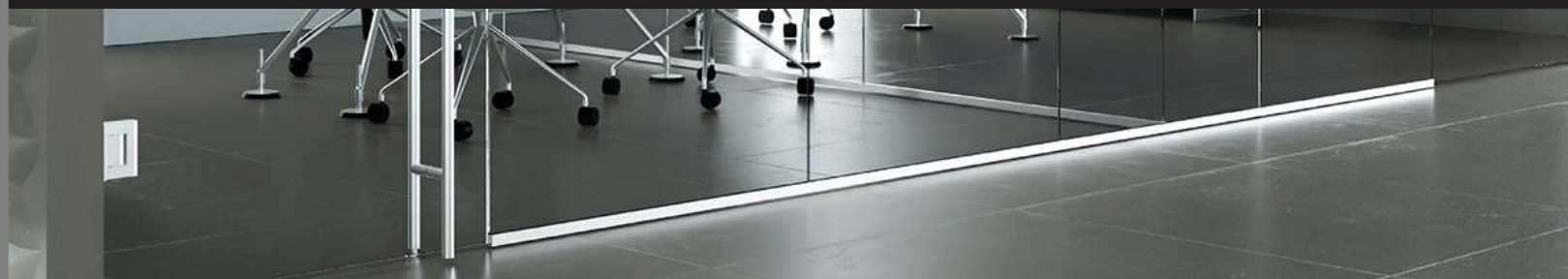
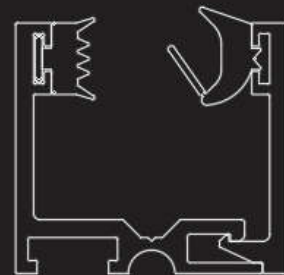



CP-35 - Framed Glass Doors

2" wide x 2-1/2" deep door jambs with optional stops for fixed glass to create seamless transitions. Providing a positive seal around the top and sides of the door in combination with optional bottom sweeps provide a frameless but sealed glass entrance.

- Reduces sound transmission in offices
- Accommodates glass up to 19mm thick
- No framing required on the door

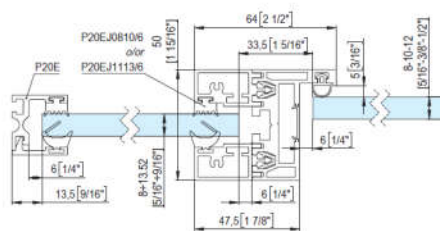
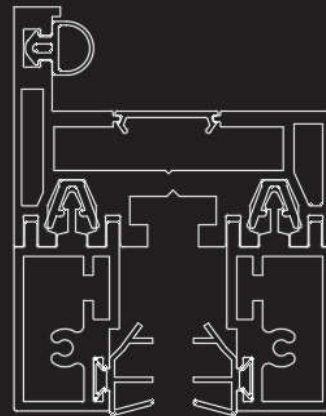

CF-70

Architectural Wall Solutions



CF-70 - Frameless Glass Sliders

Incredibly slim profile for a top-hung glass sliding door at only 50mm wide that houses both the easy-rolling carriages as well as the innovative adjustable dampers. Capable of carrying doors of up to 330lbs, it offers a one of a kind ability to be heavy-duty and low-profile without any sacrifices in quality. Mounting options;

- Ceiling Mounted
- Wall Mounted
- Glass Mounted

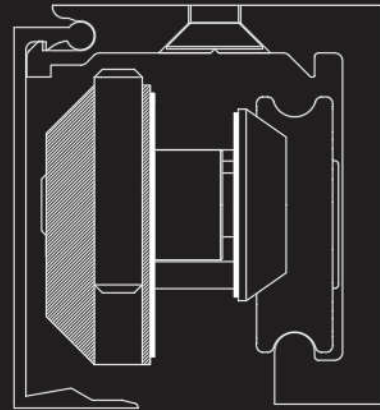



Dry-Joints



Traditional silicone contains harmful VOC's that can have negative effects to office environments. To eliminate VOC's and ensure perfect transitions in glass walls, BG offers various solutions for almost any transition. As a suitable alternative to silicone, dry-joints can minimize installation time while keeping integral bonds between glass panels secure and lasting

- High clarity
- Available for various glass thickness's of 8mm—15mm
- Excellent adhesion between glass panels
- Select joints available in black or custom colors
- Eliminate on-site VOC's

Aluminum Finishes



02—Satin Anodized
(Standard)



05—Black Anodized



13—Imitation Stainless Steel



Description	Specifications	Colours
-------------	----------------	---------

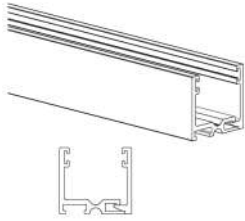

Fixed glass channel

8mm-19mm

02—Satin Anodized
05—Black
13—Imitation S.S.

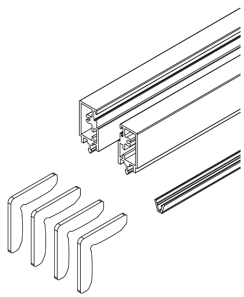

Door jamb glazing stops for adjacent fixed glass panels

8mm-19mm

02—Satin Anodized
05—Black
13—Imitation S.S.

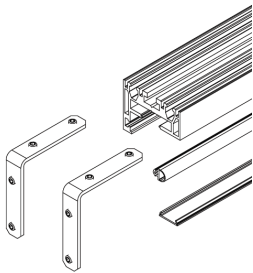

Door jambs with gaskets and corner keys to provide a seal around hinged doors

8mm-19mm

02—Satin Anodized
05—Black
13—Imitation S.S.

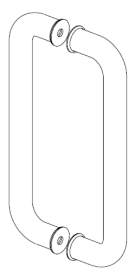
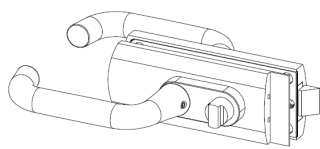
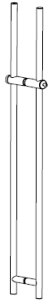
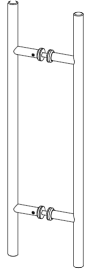
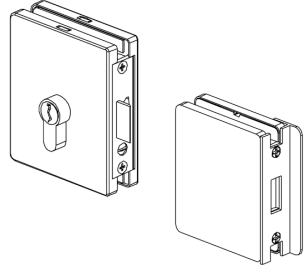

Description	Specifications	Colours
 <p>12" back to back D-shaped handle</p>	8mm-12mm	02—Satin Anodized 05—Black 21—Brushed S.S.
 <p>Horizontal lock with thumb-turn interior and SFIC lock interior. Different key combinations can be used for key/key or Key/dummy options.</p>	10mm-12mm	02—Satin Anodized 05—Black 13—Imitation S.S.
 <p>59" long locking ladder pull with thumb Turn interior and lock exterior</p>	10mm-19mm	05—Black 31—Brushed S.S.
 <p>36" long back-to-back ladder pull</p>	10mm-19mm	02—Satin Anodized 05—Black 31—Brushed S.S.
 <p>Square leverless patch lock with matching glass-mounted keeper. Keeper can be upgraded to include a 12-volt electric strike. Available on all-glass door systems, not compatible with perimeter door jambs</p>	8mm-10mm	02—Satin Anodized 05—Black 31—Brushed S.S.

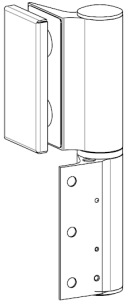
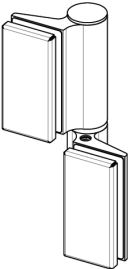
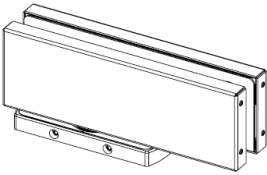

Description	Specifications	Colours
 <p>Wall mounted barrel hinges, free-swing or with built in hydraulics for self-closing doors</p>	<p>8mm-19mm 100kg Max. 47" Max. Width</p>	<p>02—Satin Anodized 05—Black 13—Imitation S.S.</p>
 <p>Glass to glass mount barrel hinges , free-swing or with built in hydraulics for self-closing doors</p>	<p>8mm-19mm 100kg Max. 40" Max. Width</p>	<p>02—Satin Anodized 05—Black 13—Imitation S.S.</p>
 <p>Top & bottom patch hinges with built in bottom Hydraulics for self-closing doors</p>	<p>8mm-12mm 100kg Max. 39" Max. Width</p>	<p>02—Satin Anodized 05—Black 13—Imitation S.S.</p>



Description

Specifications

Colours

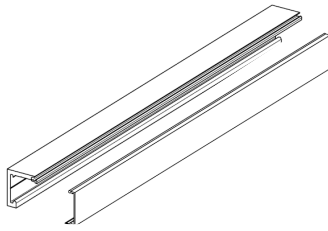

Ceiling or wall mounted sliding tracks with a minimal 2" x 2" profile available in either 2.5m lengths or 5.0m lengths

8mm - 12mm

02—Satin Anodized
05—Black (on request)

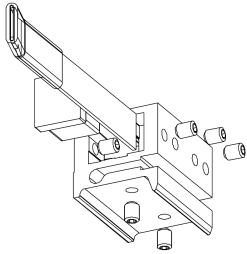

Door damper adjustable to any door weight to eliminate harsh closing as well as hold the door in the open position

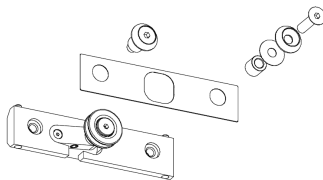

Door carriages that bolt through the door eliminating the possibility for the doors to drop. Provides height adjustability of 5/16"

100kg - 2 carriages

150kg - 3 carriages



Description

Specifications

Colours



Flexible I-Joint for glass-to-glass butt joints

8mm-12mm

Clear



3-way Joint for glass-to-glass butt joints
where there is an intersecting adjacent
panel

8mm-12mm

Clear



Square corner joint for glass-to-glass corner
seams

8mm-12mm

Clear
Black

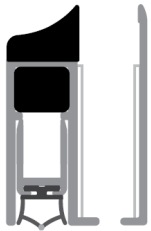

Drop down door seal with 13mm of travel
That adheres to the door with high-bond tape

8mm-12mm

02—Satin Anodized